

SERIES 94 SQUARE CARBURETOR USED ON 7.5, .67, .82, .91 AND 1.00

COMPLETE LATER STYLE CARBURETOR

ALL NECK DIAMETER = .625"

7.5 - THROAT - = 80-8701 (FI) 80-8722 (RI)

7.5 .67 .82 .91 1.00 - THROAT ϕ .456 - = 80-6701 (FI) 80-67xx (RI)

.67 .82 .91 1.00 - THROAT ϕ .483 - = 80-6702

1.00 AERO - THROAT DIA - = 80-8701

ALL REQUIRED
REMOTE NEEDLE
PN 9255

PLEASE CALL US IF NO PART NUMBER OR PART NUMBER CONTAINS XX

LATER STYLE CARB

DURING STYLE CHANGE, PARTS
MAY HAVE BEEN MIXED
BETWEEN BOTH CARBS.

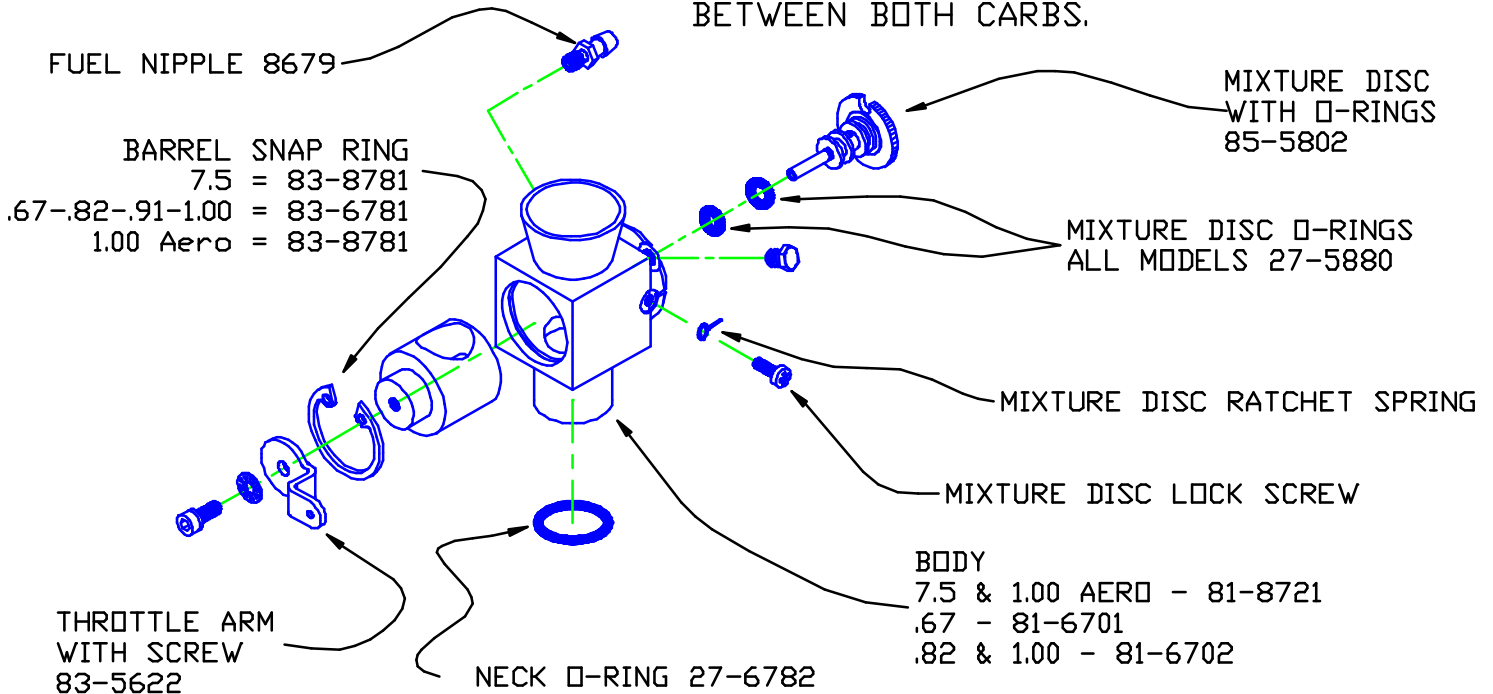

EARLY STYLE CARB

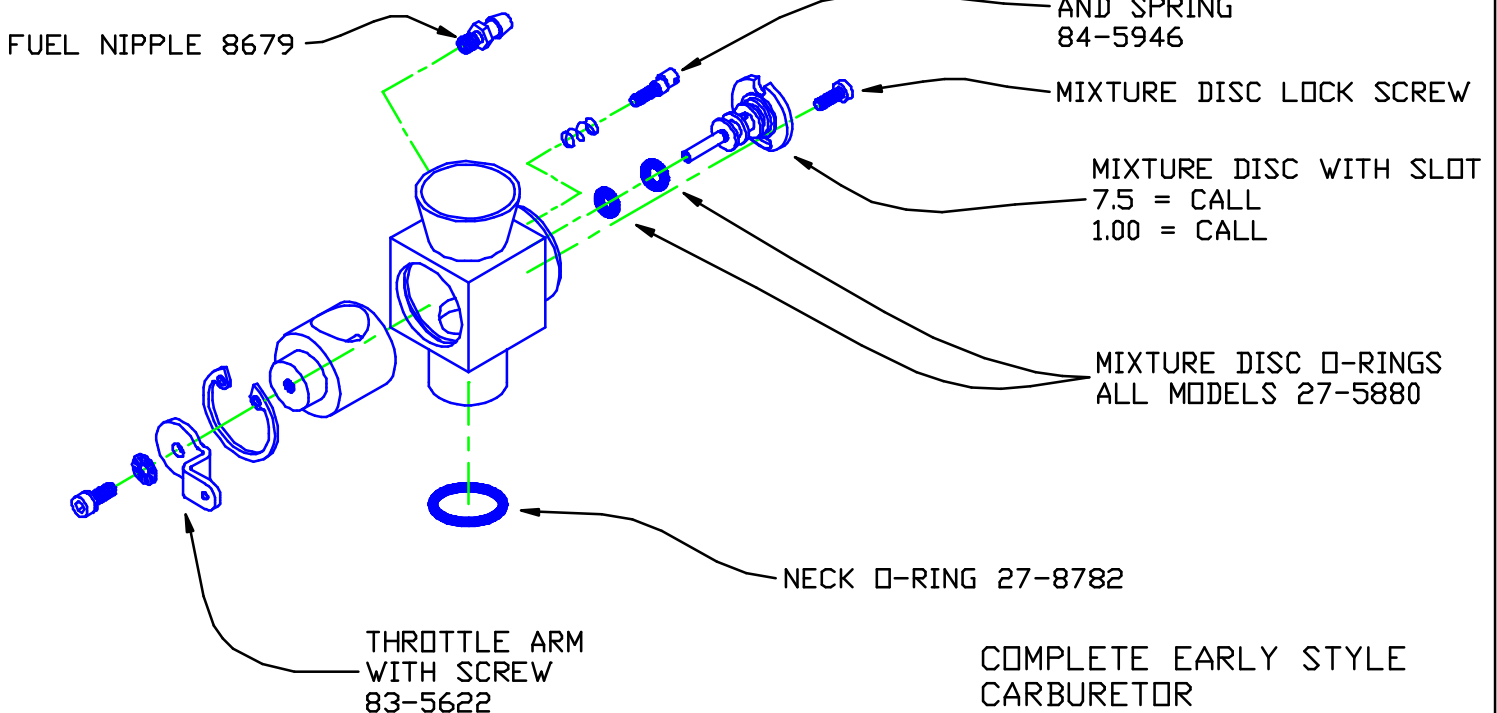

COMPLETE EARLY STYLE
CARBURETOR
NO LONGER AVAILABLE