

# K&B 7.5 SEMI-PRO OUTBOARD #7510

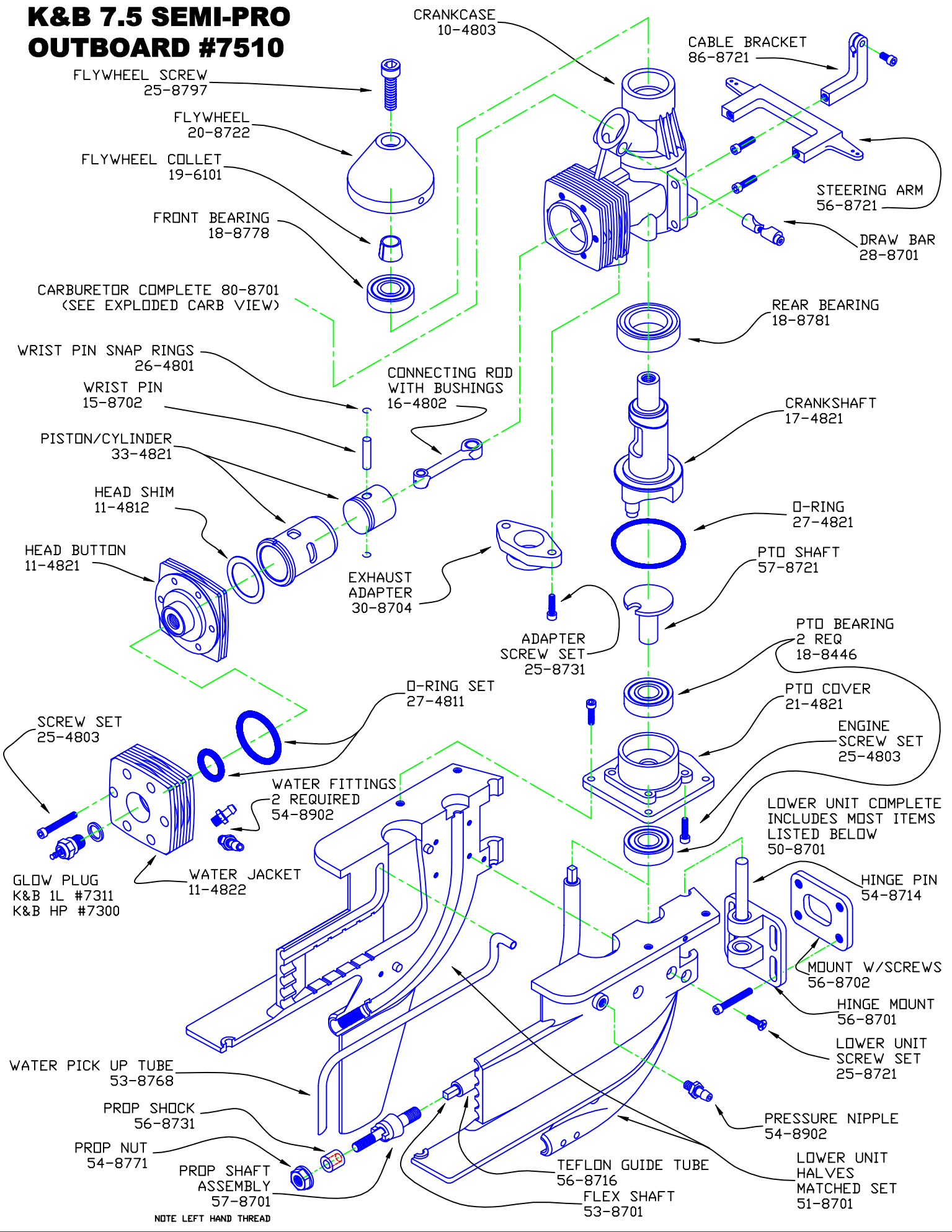

CRANKCASE  
10-4803

CABLE BRACKET  
86-8721

FLYWHEEL SCREW  
25-8797

FLYWHEEL  
20-8722

FLYWHEEL COLLET  
19-6101

FRONT BEARING  
18-8778

STEERING ARM  
56-8721

DRAW BAR  
28-8701

CARBURETOR COMPLETE 80-8701  
(SEE EXPLODED CARB VIEW)

REAR BEARING  
18-8781

WRIST PIN SNAP RINGS  
26-4801

WRIST PIN  
15-8702

CONNECTING ROD  
WITH BUSHINGS  
16-4802

CRANKSHAFT  
17-4821

PISTON/CYLINDER  
33-4821

HEAD SHIM  
11-4812

HEAD BUTTON  
11-4821

EXHAUST  
ADAPTER  
30-8704

ADAPTER  
SCREW SET  
25-8731

O-RING  
27-4821

PTO SHAFT  
57-8721

PTO BEARING  
2 REQ  
18-8446

PTO COVER  
21-4821

ENGINE  
SCREW SET  
25-4803

SCREW SET  
25-4803

O-RING SET  
27-4811

WATER FITTINGS  
2 REQUIRED  
54-8902

LOWER UNIT COMPLETE  
INCLUDES MOST ITEMS  
LISTED BELOW  
50-8701

GLOW PLUG  
K&B 1L #7311  
K&B HP #7300

WATER JACKET  
11-4822

HINGE PIN  
54-8714

MOUNT W/SCREWS  
56-8702

HINGE MOUNT  
56-8701

LOWER UNIT  
SCREW SET  
25-8721

WATER PICK UP TUBE  
53-8768

PROP SHOCK  
56-8731

PROP NUT  
54-8771

PROP SHAFT  
ASSEMBLY  
57-8701

NOTE LEFT HAND THREAD

PRESSURE NIPPLE  
54-8902

TEFLON GUIDE TUBE  
56-8716

FLEX SHAFT  
53-8701

LOWER UNIT  
HALVES  
MATCHED SET  
51-8701